

GROUND FLOOR PLAN
TOWER - 1 (G+12)

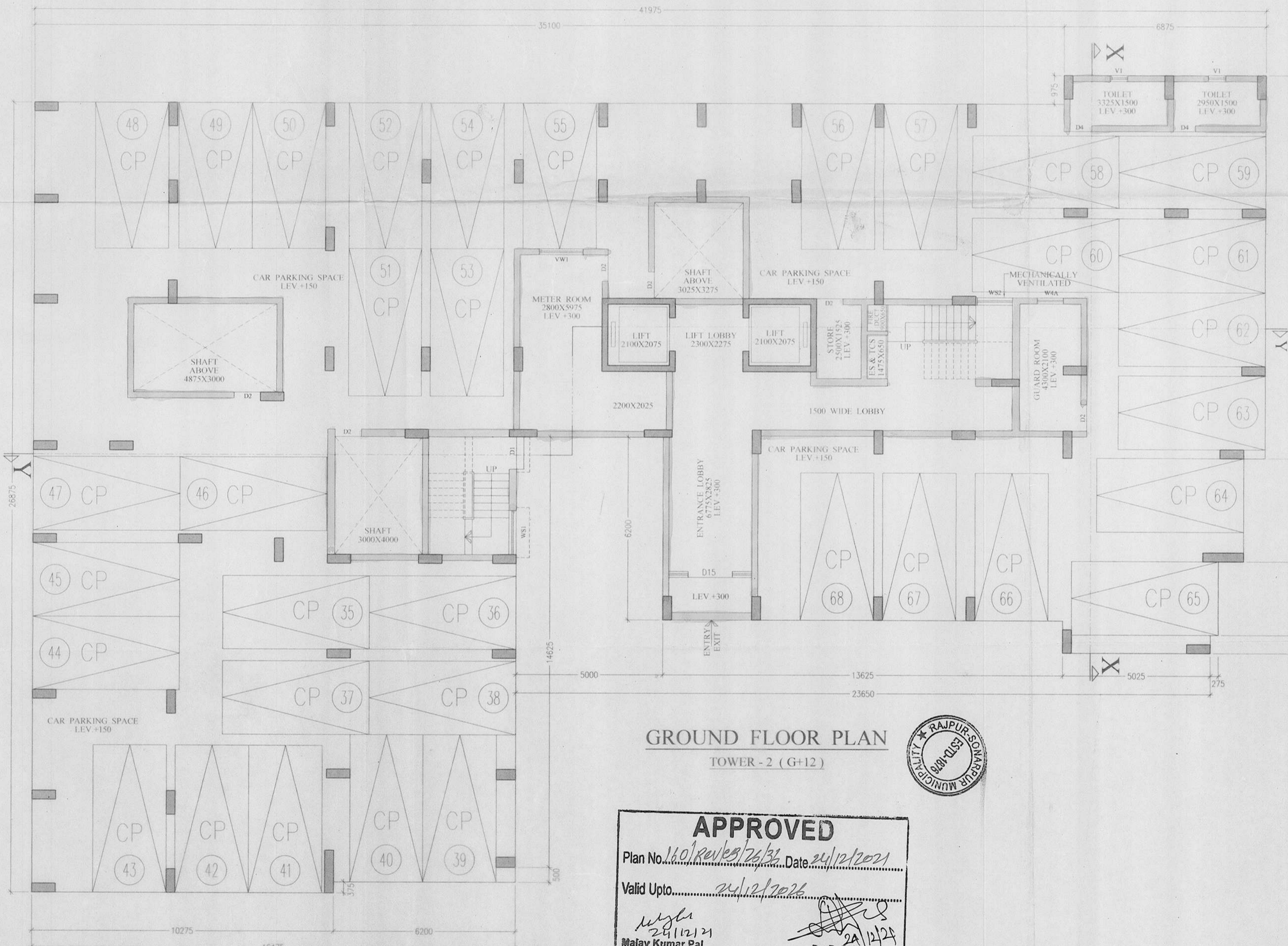

GROUND FLOOR PLAN
TOWER - 2 (G+12)

SCHEDULE OF DOORS & WINDOWS							
TYPE	SILL	UNTEL	SIZE	TYPE	SILL	UNTEL	SIZE
D1	-	2100	1100x2100	W1	900	2100	1500x1200
D2	-	2100	900x2100	W2	900	2100	1500x1200
D3	-	2100	825x2100	W3	900	2100	1500x1200
D4	-	2100	750x2100	W4	900	2400	900x1200
DW1	-	2100	1800x2100	WK1	1050	2100	600x1050
DW2	-	2100	1500x2100	WK2	1050	2100	750x1050
				WK3	1050	2100	600x1050
				WS1	900	2100	1500x1200
				WS2	900	2100	1200x1200
				V1	1200	2100	1800x900

GENERAL NOTES

1. ALL DIMENSIONS ARE IN MM.
2. ALL EXTERNAL WALLS 250TH & 200TH & INTERNAL WALLS 125 & 75 THK. UNLESS OTHERWISE MENTIONED.
3. ALL MASONRY WORKS ARE BOUNDED BY CEMENT-MORTAR (1:6) & (1:4).
4. EXTERNAL PLASTER IS 25TH & INTERNAL PLASTER IS 12MM TH WITH 1:4 MORTAR.
5. ALL CONC. GRADE IS M200 (1:1.5:3).

As Lawfully Constituted Attorney of
Ambalika Housing (P) Ltd.
Mritika Builders (P) Ltd.
Nepal Trade Com (P) Ltd.

CERTIFICATE OF STRUCTURAL ENGINEER

I/WE DO HEREBY CERTIFY THAT THE FOUNDATION AND SUPER STRUCTURE OF THE BUILDING PROPOSED FOR CONSTRUCTION AT HOLDING NO. 153 SCHOOL ROAD, WARD NO. 26, UNDER THE JURISDICTION OF RAJPUR SONARPUR MUNICIPALITY HAVE BEEN PERSONALLY INSPECTED AND SO DESIGN BY ME/US WILL MAKE SUCH FOUNDATION AND SUPERSTRUCTURE SAFE IN ALL RESPECT INCLUDING THE CONSIDERATION OF BEARING CAPACITY AND SETTLEMENT OF SOIL AND OTHER CONDITIONS, IF ANY, CONFIRMING TO ALL STIPULATIONS OF ALL RELEVANT IS CODE OF PRACTICE AND NATIONAL BUILDING CODE.

DIPANKAR BHOWMIK
B.E., M.I.E., F.I.V.
ENLISTMENT NO. ESE 91/RIPSON/ESE/2014-15
RAJPUR - SONARPUR MUNICIPALITY

ALOK ROY
Enlisted Geotechnical Engineer
Rajpur-Sonarpur Municipality
No.-008/G.T. Eng., Class-I

SANJIV J. PAREKH
M.E. (STRUCT.), M.E. (CONST.ENG.),
F.S.R. NO. 100, RAJPUR
SONARPUR MUNICIPALITY.

Rajkumar Agarwal
Architect
Member of Council of
Architecture CA / 91 / 17940

TOWER - 1 & 2
GROUND FLOOR PLANS

PROJECT
REVISED G+12 (39.95 MTR. HT.) STORIED RESIDENTIAL BUILDING COMPLEX AT HOLDING NO. 153 SCHOOL RD. R.S. DAG NO. 51, 52, 53, 54, 56, 57 & 58, R.S. KHATAN NO. 2509, 2510, 60, 2. MOUZA - RAJPUR, J.L. NO 55, WARD NO. 26. P.S. SONARPUR, DIST - 24PGS(S), UNDER RAJPUR SONARPUR MUNICIPALITY. VIDE SANC. PLAN NO. 858/CB/26/75. DATED=30.09.2015

OWNERS NAME
I/M/S AMBALIKA HOUSING PVT. LTD. & OTHERS.

DATE	JOB. NO.	DEALT	CHECKED	SHEET NO.
15.09.2021	ARCH/2014/521		ANMESH	3 OF 7

ARCHITECT
RAJ AGRAWAL & ASSOCIATES
88, ROYD STREET, KOLKATA - 16

Sanyalson Associates
Consultant Pvt. Ltd.
CONSULTANT PLANNING & STRUCTURAL ENGINEERS
KANUNGO PARK

Checked by
(AJIT GHARA) Sub-Assistant Engineer
RAJPUR SONARPUR MUNICIPALITY

FOR OFFICE USE ONLY

APPROVED
Plan No. 11.0/RAJES/26/26 Date 24/12/2021
Valid Upto 24/12/2026

Malay Kumar Pal
Assistant Engineer
In Charge, P.W.D.
RAJPUR-SONARPUR MUNICIPALITY

Dr. Pallab Das
Chairperson
Board of Administrators

